



TRADITION OF BUILDING **EXCELLENCE**

[www.arbormeadowsct.com](http://www.arbormeadowsct.com) 203.265.1821



## 10 IRIS COURT, CROMWELL

### PROPERTY DETAILS:

**2,574**  
SQUARE FEET

**3**  
BEDROOMS

**2.1**  
BATHROOMS

**2**  
CAR GARAGE

FIRST FLOOR  
OWNER'S BEDROOM

NEW HOMES BY  
**Calcagni**  
REAL ESTATE



Artist's Rendering. The rendering/floor plans and photos may not reflect the exact features, colors, or dimensions of the house and may be shown with extra cost options. All dimensions are approximate and subject to change. Please consult with our Sales Representative for actual specifications.

## FLOOR PLANS

- 1st Floor Owner's Suite with Expansive Walk-In Closet
- 1st Floor Study/Office
- 1st Floor Laundry Room
- Large Walk-In Pantry
- Dining Room Built-Ins
- Mudroom Built-Ins
- Family Room with Cathedral Ceilings
- 2 Car Garage
- Gas Fireplace with Slate Surround and Custom Floating Mantel
- Detailed Trim Throughout
- 12 x 20 Rear Paver Patio
- Custom Cabinetry with Quartz Countertops
- Oak Flooring Throughout
- Owner's Bath has European Tiled Shower
- 98% Efficient Navien Tankless Water Heater with Circulator Loop

### FIRST FLOOR



### SECOND FLOOR

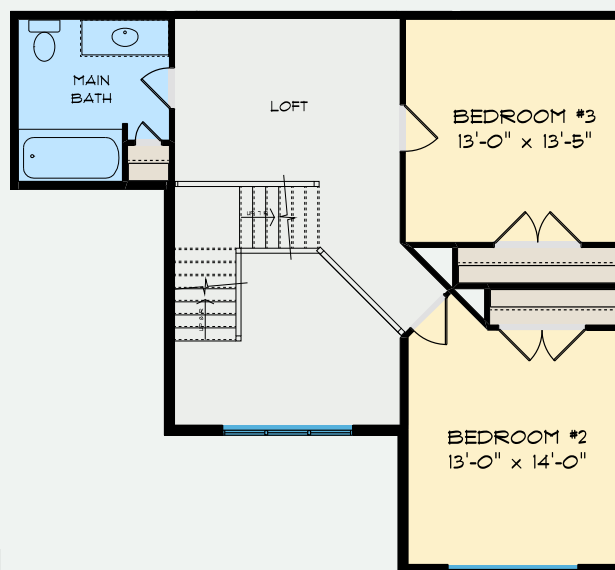

NEW HOMES BY  
**Calcagni**  
REAL ESTATE



Artist's Rendering. The rendering/floor plans and photos may not reflect the exact features, colors, or dimensions of the house and may be shown with extra cost options. All dimensions are approximate and subject to change. Please consult with our Sales Representative for actual specifications.